

APPENDIX B
(Volume 3 of 4)

Project Maps

Mainline Facilities MP 545–648

APPENDIX B Volume 3: Project Maps – Mainline Facilities MP 545–648

Table of Contents

Mainline Facilities (cont'd).....B-118

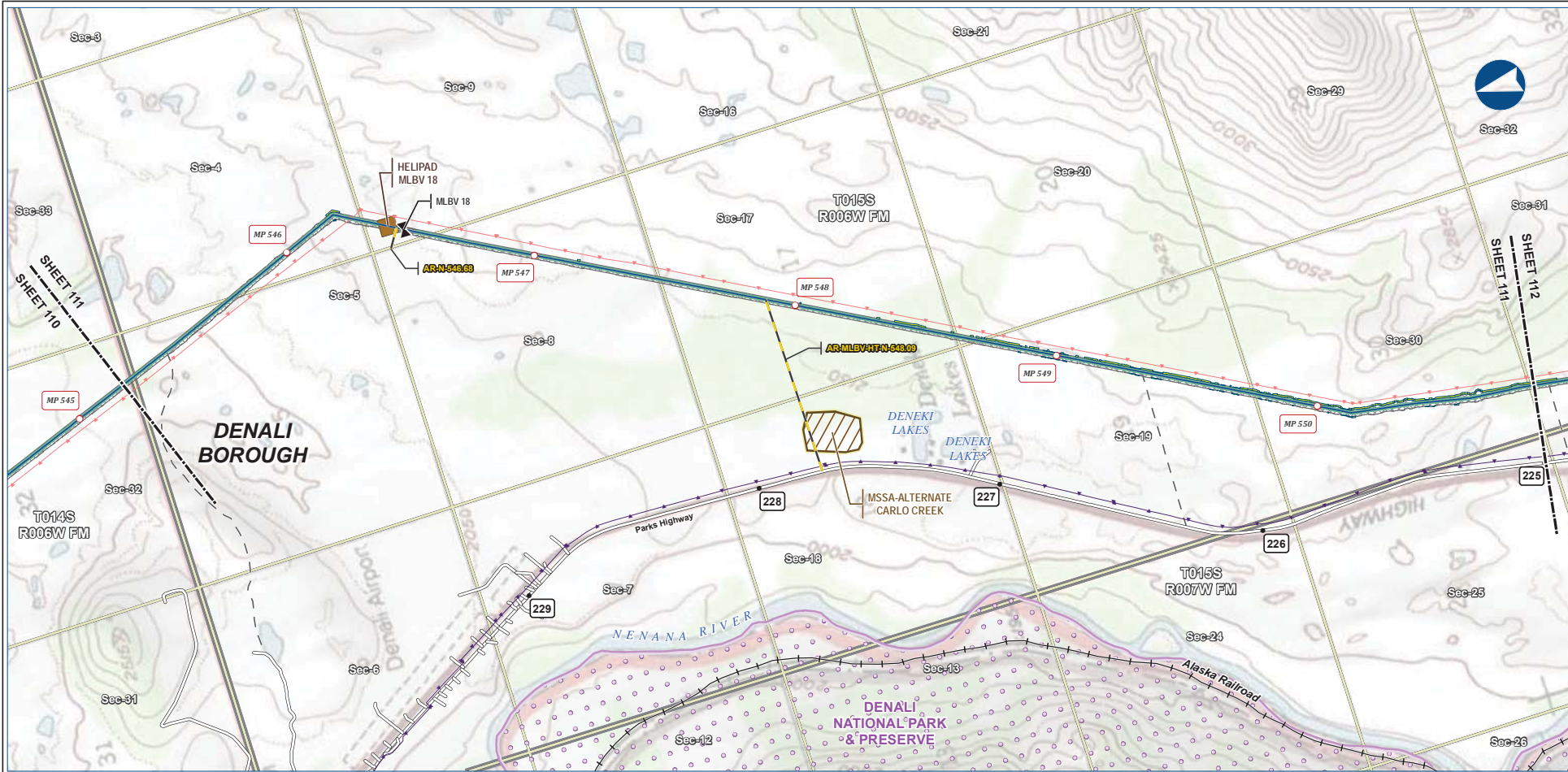

B-118



Legend		EXISTING FEATURES	
	Mainline Pipeline		Existing Roads
	Construction ROW		Railroad
	Access Road - Gravel		Off Road Trails
	Mainline Blockvalve		Buried Cable
	Helipad		Overhead Powerline
			Conservation Lands
			Material Site Study Area (MSSA)
			Section
			Township

ALASKA LNG PROJECT			
Preliminary Facility Locations			
Mainline Rev C2 Route			
BOROUGH:	DENALI	DRAWN BY:	AGDC
STATE:	ALASKA	CHECKED BY:	
REV. NO.:	REVISION	DATE	
A	ISSUED FOR REVIEW	2017-03-10	
PRELIMINARY			
1:24,000			
DATE: 2017-03-10	PROJECTION: NAD83 NSRS2007 ALASKAZONE4 FTUS 54392	DWG: RR_1_APPENDIX_A1_MAINLINE_TOPO_REV_C2_CL	SHEET: 111

DISCLAIMER

The information contained herein is for informational or planning purposes only. It does not nor should it be deemed to be an offer, request or proposals for rights or occupation of any kind. The Alaska LNG Project Participants and their respective officers, employees and agents, make no warranty, implied or otherwise, nor accept any liability, as to the accuracy or completeness of the information contained in these documents, drawings or electronic files. Do not remove or delete this note from document, drawing or electronic file.

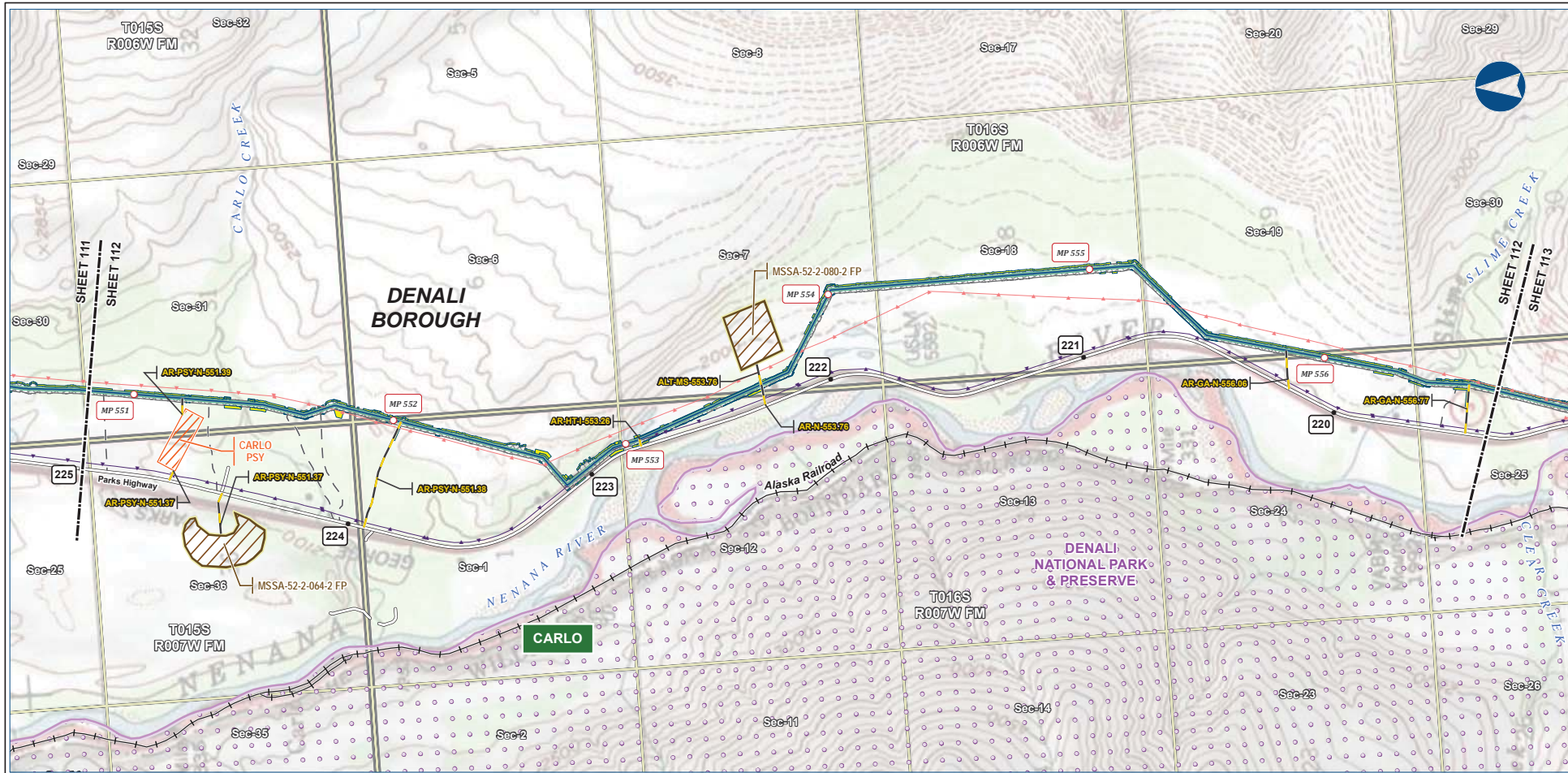

B-119



Legend		EXISTING FEATURES	
Mainline Pipeline	Permanent ROW	Existing Roads	Railroad
Access Road - Gravel	Construction ROW	Off Road Trails	Buried Cable
Pipe Storage Yard (PSY)	ATWS	Overhead Powerline	Conservation Lands
Material Site Study Area (MSSA)	Alaska DOT Place Names	Section	Township

ALASKA LNG PROJECT Preliminary Facility Locations Mainline Rev C2 Route			
BOROUGH:	DENALI	DRAWN BY:	AGDC
STATE:	ALASKA	CHECKED BY:	
REV. NO.:	REVISION	DATE	
A	ISSUED FOR REVIEW	2017-03-10	
PRELIMINARY			
1:24,000			
DATE: 2017-03-10	PROJECTION: NAD83 NRSR2007 ALASKAZONE4 FTUS 54392	DWG: RR-1_APPENDIX_A1_MAINLINE_TOPO_REV_C2_CL	SHEET: 112

DISCLAIMER

The information contained herein is for informational or planning purposes only. It does not nor should it be deemed to be an offer, request or proposals for rights or occupation of any kind. The Alaska LNG Project Participants and their respective officers, employees and agents, make no warranty, implied or otherwise, nor accept any liability, as to the accuracy or completeness of the information contained in these documents, drawings or electronic files. Do not remove or delete this note from document, drawing or electronic file.

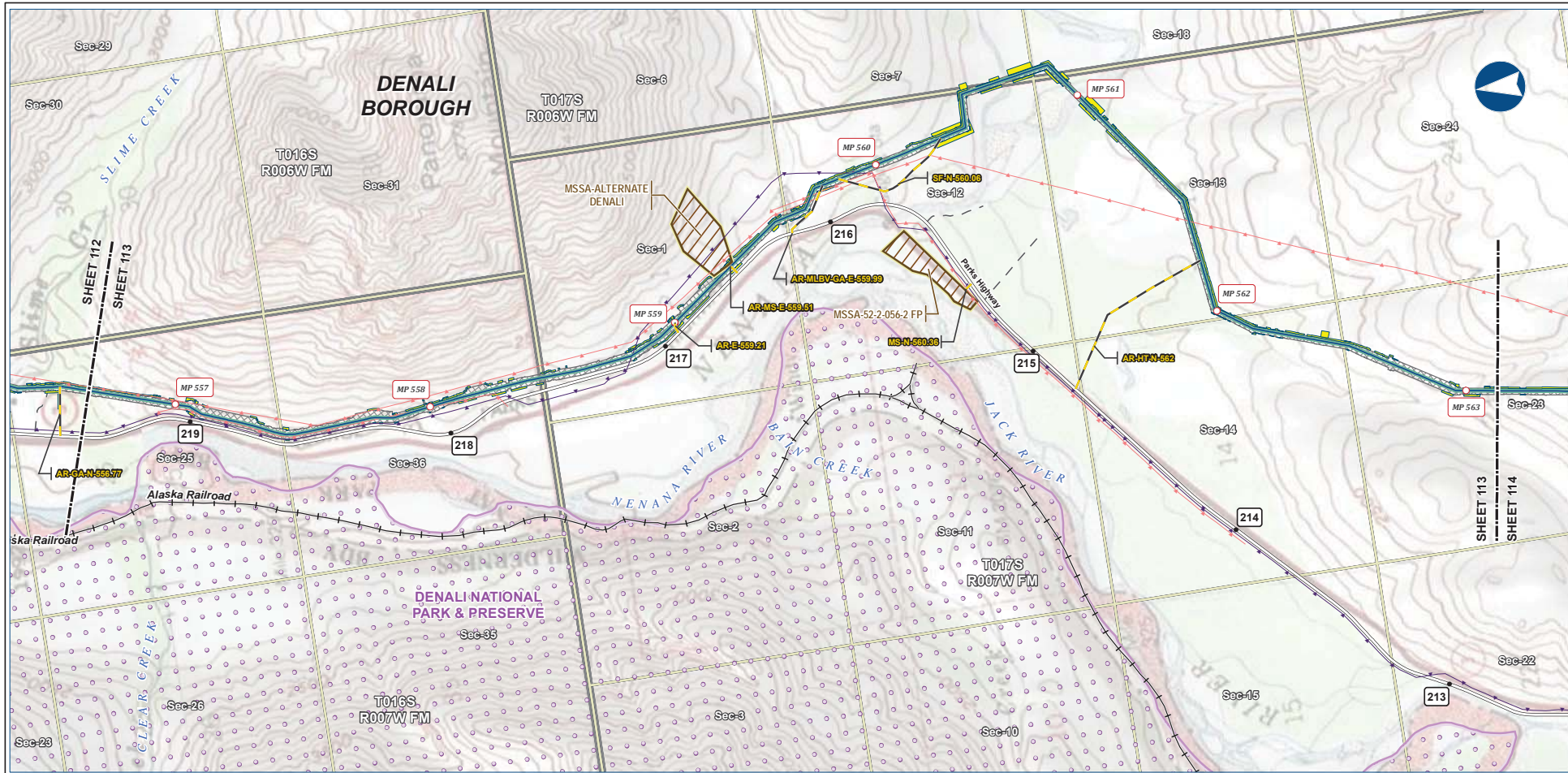

B-120

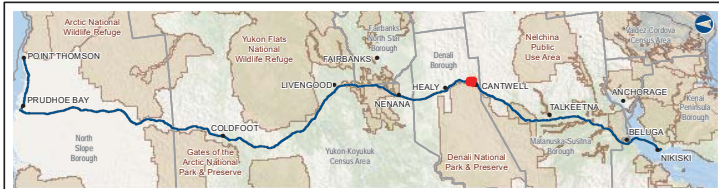

PIPELINE		EXISTING FEATURES	
	Mainline Pipeline		Permanent ROW
	Construction ROW		Existing Roads
	Access Road - Gravel		Railroad
	ATWS		Off Road Trails
	Material Site Study Area (MSSA)		Buried Cable
			Overhead Powerline
			Conservation Lands
			Section
			Township

ALASKA LNG PROJECT			
Preliminary Facility Locations			
Mainline Rev C2 Route			
BOROUGH:	DENALI	DRAWN BY:	AGDC
STATE:	ALASKA	CHECKED BY:	
REV. NO.:	REVISION	DATE	
A	ISSUED FOR REVIEW	2017-03-10	
PRELIMINARY			
1:24,000			
DATE:	2017-03-10	PROJECTION:	NAD83 NRSR2007 ALASKAZONE4 FTUS S4392

DISCLAIMER

The information contained herein is for informational or planning purposes only. It does not nor should it be deemed to be an offer, request or proposals for rights or occupation of any kind. The Alaska LNG Project Participants and their respective officers, employees and agents, make no warranty, implied or otherwise, nor accept any liability, as to the accuracy or completeness of the information contained in these documents, drawings or electronic files. Do not remove or delete this note from document, drawing or electronic file.

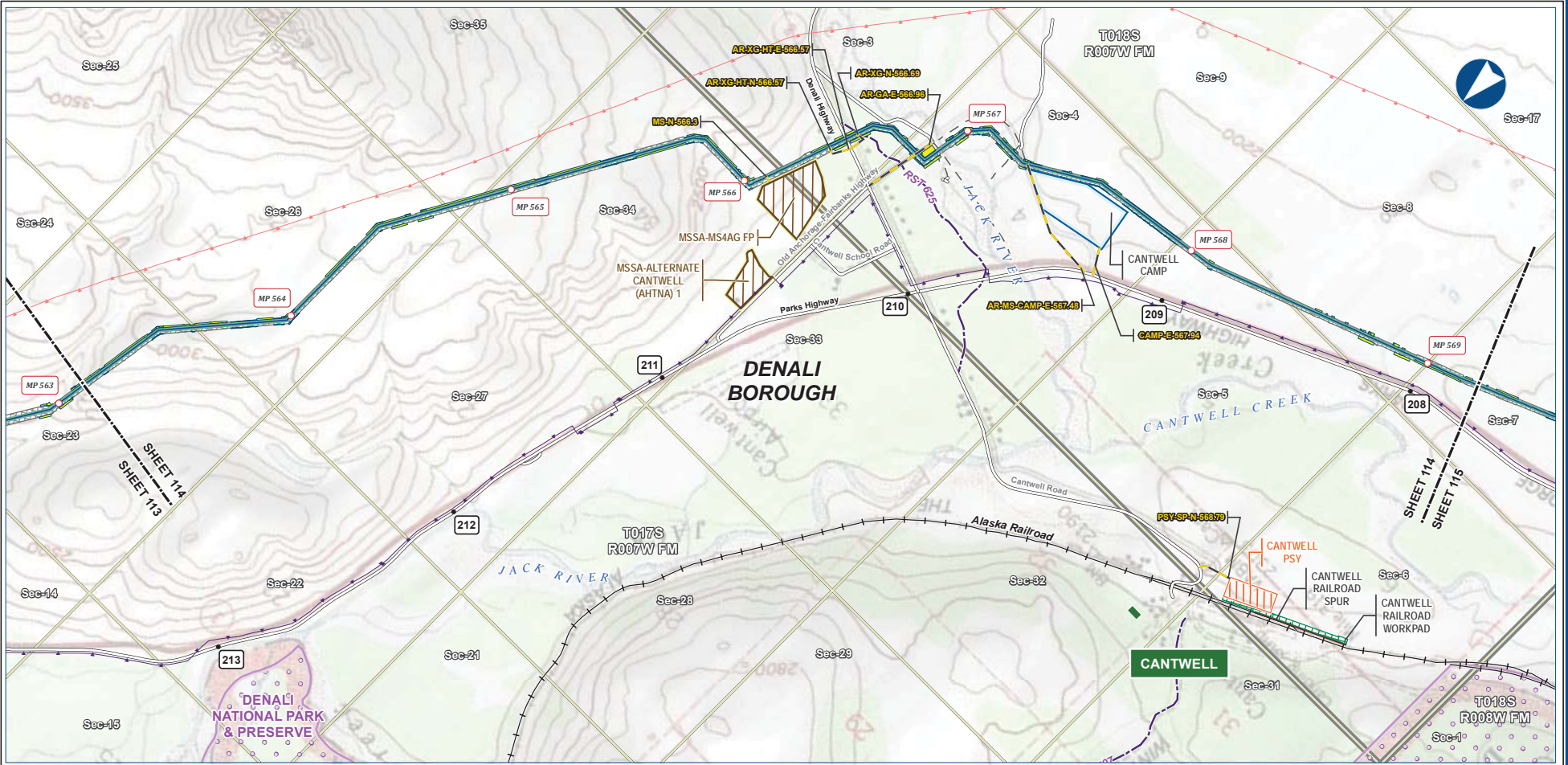

B-121



Legend		EXISTING FEATURES	
Permanent ROW	Mainline Pipeline	Existing Roads	Railroad
Construction ROW	ATWS	Revised Statute 2477 Trail	Off Road Trails
Off ROW Camp	Pipe Storage Yard (PSY)	Buried Cable	Overhead Powerline
Railroad Workpad	Railroad Spur	Conservation Lands	Alaska DOT Place Names
Material Site Study Area (MSSA)		Section	Township

ALASKA LNG PROJECT Preliminary Facility Locations Mainline Rev C2 Route			
BOROUGH:	DENALI	DRAWN BY:	AGDC
STATE:	ALASKA	CHECKED BY:	
REV. NO.:	REVISION	DATE	
A	ISSUED FOR REVIEW	2017-03-10	
PRELIMINARY			
1:24,000			
DATE:	2017-03-10	PROJECTION:	NAD83 NRSR2007 ALASKAZONE4 FTUS 54392

DISCLAIMER

The information contained herein is for informational or planning purposes only. It does not nor should it be deemed to be an offer, request or proposals for rights or occupation of any kind. The Alaska LNG Project Participants and their respective officers, employees and agents, make no warranty, implied or otherwise, nor accept any liability, as to the accuracy or completeness of the information contained in these documents, drawings or electronic files. Do not remove or delete this note from document, drawing or electronic file.

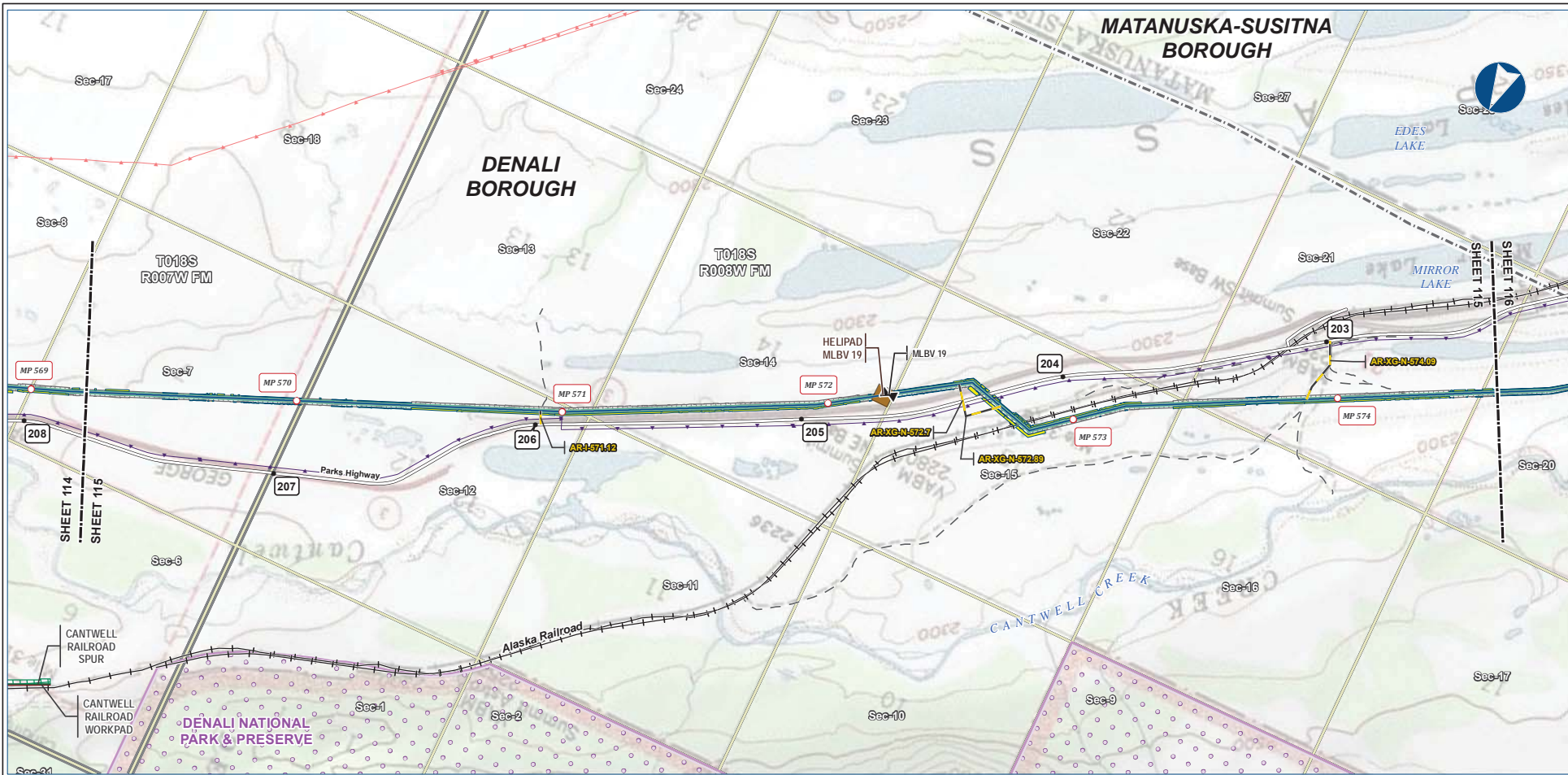

B-122

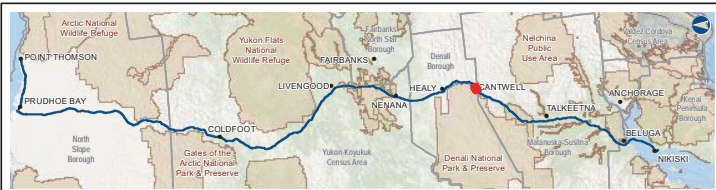

Legend	
PIPELINE	Permanent ROW
Mainline Pipeline	Construction ROW
Access Road - Gravel	ATWS
Mainline Blockvalve	Railroad Workpad
Helipad	Railroad Spur
	EXISTING FEATURES
	Existing Roads
	Railroad
	Off Road Trails
	Buried Cable
	Overhead Powerline
	Borough / Census Area
	Conservation Lands
	Section
	Township

ALASKA LNG PROJECT			
Preliminary Facility Locations			
Mainline Rev C2 Route			
BOROUGH:	DENALI	DRAWN BY:	AGDC
STATE:	ALASKA	CHECKED BY:	
REV. NO.:	REVISION	DATE	
A	ISSUED FOR REVIEW	2017-03-10	
PRELIMINARY			
1:24,000			
DATE:	2017-03-10	PROJECTION:	NAD83 NSRS2007 ALASKAZONE4 FTUS 54392

DISCLAIMER

The information contained herein is for informational or planning purposes only. It does not nor should it be deemed to be an offer, request or proposals for rights or occupation of any kind. The Alaska LNG Project Participants and their respective officers, employees and agents, make no warranty, implied or otherwise, nor accept any liability, as to the accuracy or completeness of the information contained in these documents, drawings or electronic files. Do not remove or delete this note from document, drawing or electronic file.

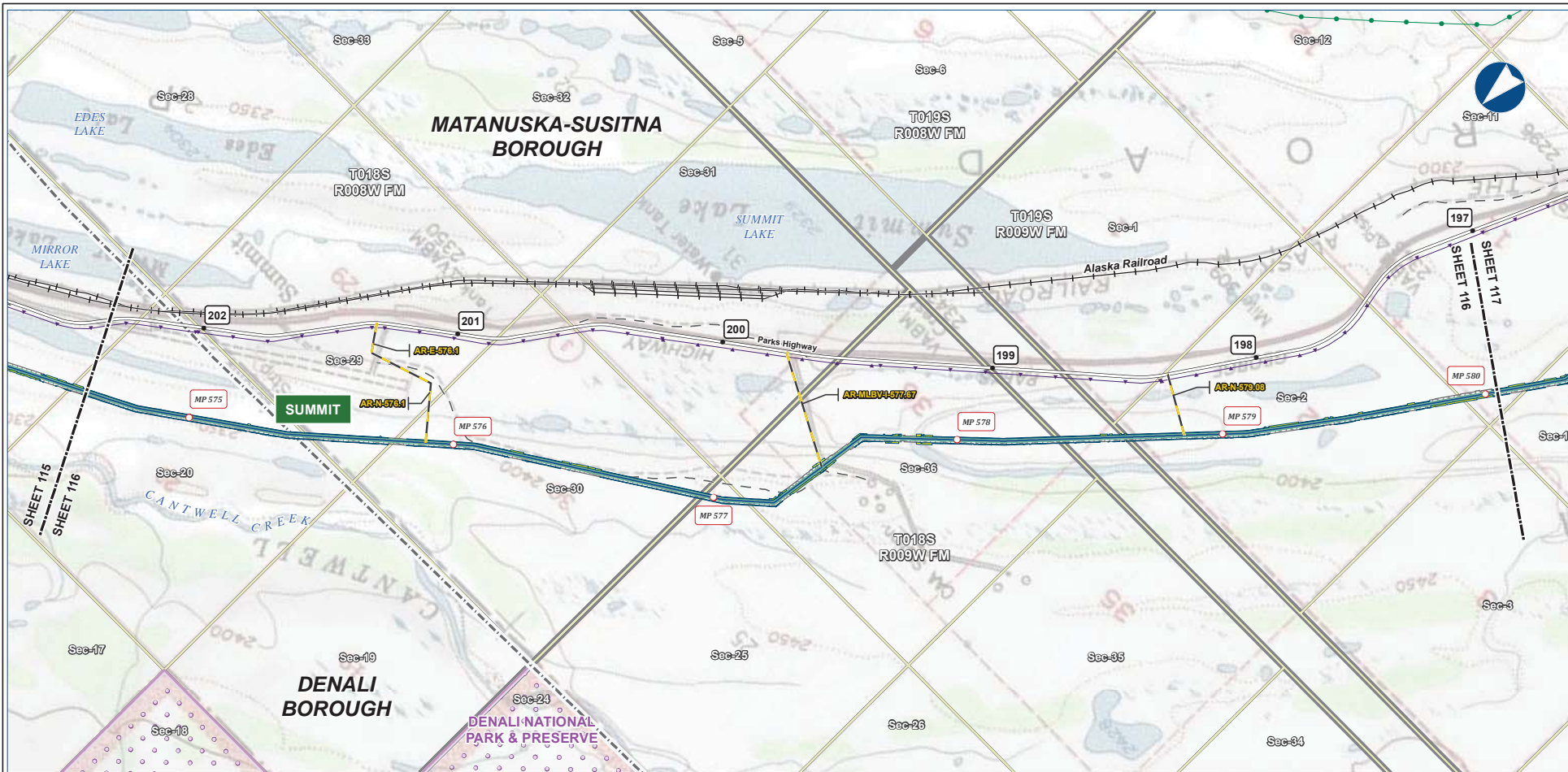

B-123



Legend		EXISTING FEATURES	
Mainline Pipeline	Permanent ROW	Existing Roads	Railroad
Access Road - Gravel	Construction ROW	Off Road Trails	Existing Pipeline
ATWS		Buried Cable	Borough / Census Area
		Conservation Lands	Alaska DOT Place Names
		Section	Township

ALASKA LNG PROJECT Preliminary Facility Locations Mainline Rev C2 Route			
BOROUGH:	MATANUSKA-SUSITNA	DRAWN BY:	AGDC
STATE:	ALASKA	CHECKED BY:	
REV. NO.:	REVISION	DATE	
A	ISSUED FOR REVIEW	2017-03-10	
PRELIMINARY			
1:24,000			
DATE: 2017-03-10	PRODUCTION: NAD83 NSRS2007 ALASKAZONE4 FTUS 54392	DWG: RR-1_APPENDIX_A1_MAINLINE_TOPO_REV_C2_CL	SHEET: 116

DISCLAIMER
The information contained herein is for informational or planning purposes only. It does not nor should it be deemed to be an offer, request or proposals for rights or occupation of any kind. The Alaska LNG Project Participants and their respective officers, employees and agents, make no warranty, implied or otherwise, nor accept any liability, as to the accuracy or completeness of the information contained in these documents, drawings or electronic files. Do not remove or delete this note from document, drawing or electronic file.

PRELIMINARY FACILITY LOCATIONS - MAINLINE REV C2 ROUTE

ALASKA LNG

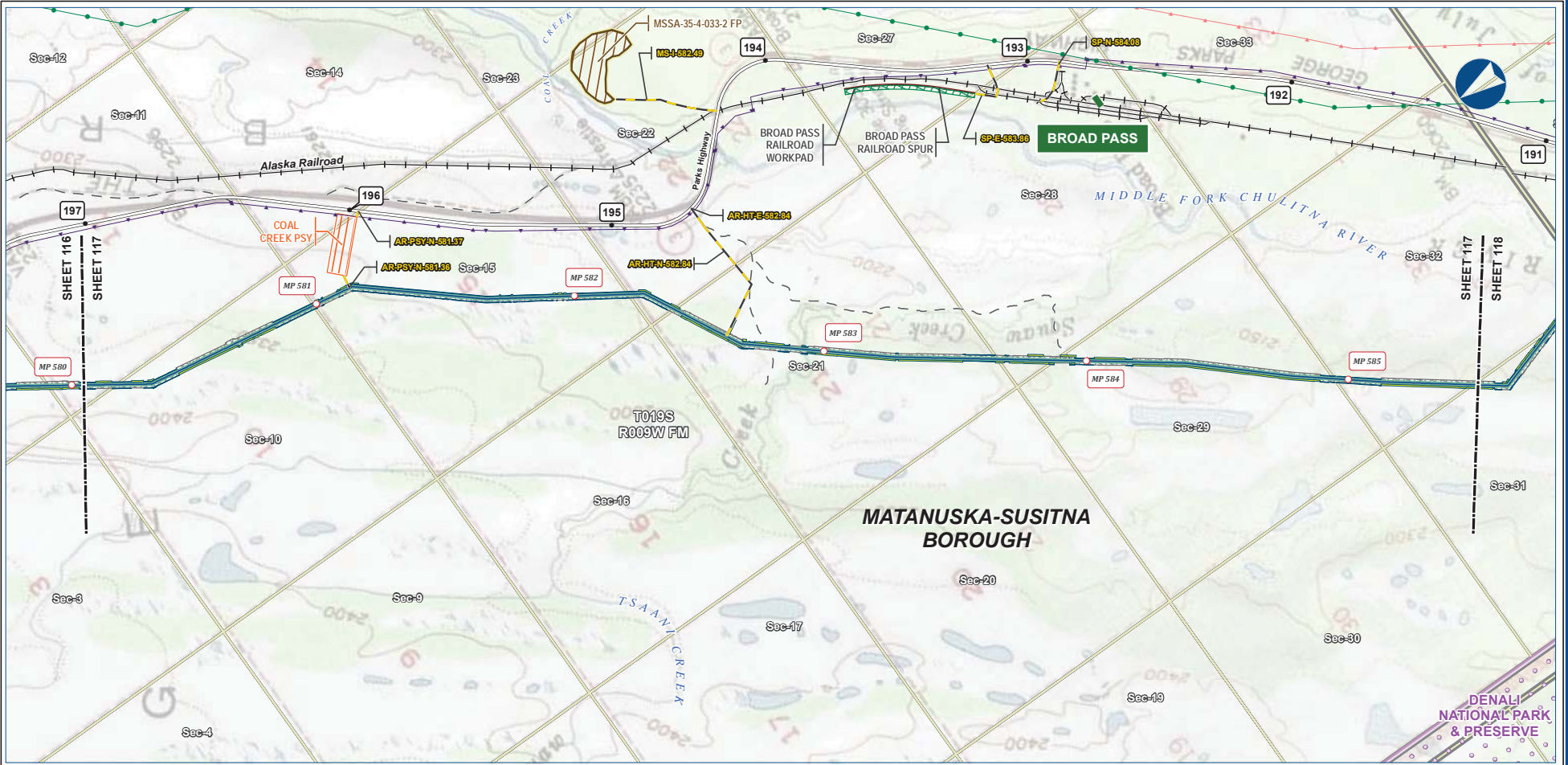

B-124



Alaska LNG Project

PIPELINE		EXISTING FEATURES	
	Mainline Pipeline		Existing Roads
	Construction ROW		Railroad
	Access Road - Gravel		Off Road Trails
	Permanent ROW		Existing Pipeline
	ATWS		Buried Cable
	Pipe Storage Yard (PSY)		Overhead Powerline
	Railroad Workpad		Conservation Lands
	Railroad Spur		Alaska DOT Place Names
	Material Site Study Area (MSSA)		Section
			Township

ALASKA LNG PROJECT Preliminary Facility Locations Mainline Rev C2 Route			
BOROUGH:	MATANUSKA-SUSITNA	DRAWN BY:	AGDC
STATE:	ALASKA	CHECKED BY:	
REV. NO.:	REVISION	DATE	
A	ISSUED FOR REVIEW	2017-03-10	
PRELIMINARY			
1:24,000			
DATE: 2017-03-10	PROJECTION: NAD83 NSRS2007 ALASKAZONE4 FTUS 54392	DWG: RR-1_APPENDIX_A1_MAINLINE_TOPO_REV_C2_CL	SHEET: 117

DISCLAIMER

The information contained herein is for informational or planning purposes only. It does not nor should it be deemed to be an offer, request or proposals for rights or occupation of any kind. The Alaska LNG Project Participants and their respective officers, employees and agents, make no warranty, implied or otherwise, nor accept any liability, as to the accuracy or completeness of the information contained in these documents, drawings or electronic files. Do not remove or delete this note from document, drawing or electronic file.

PRELIMINARY FACILITY LOCATIONS - MAINLINE REV C2 ROUTE

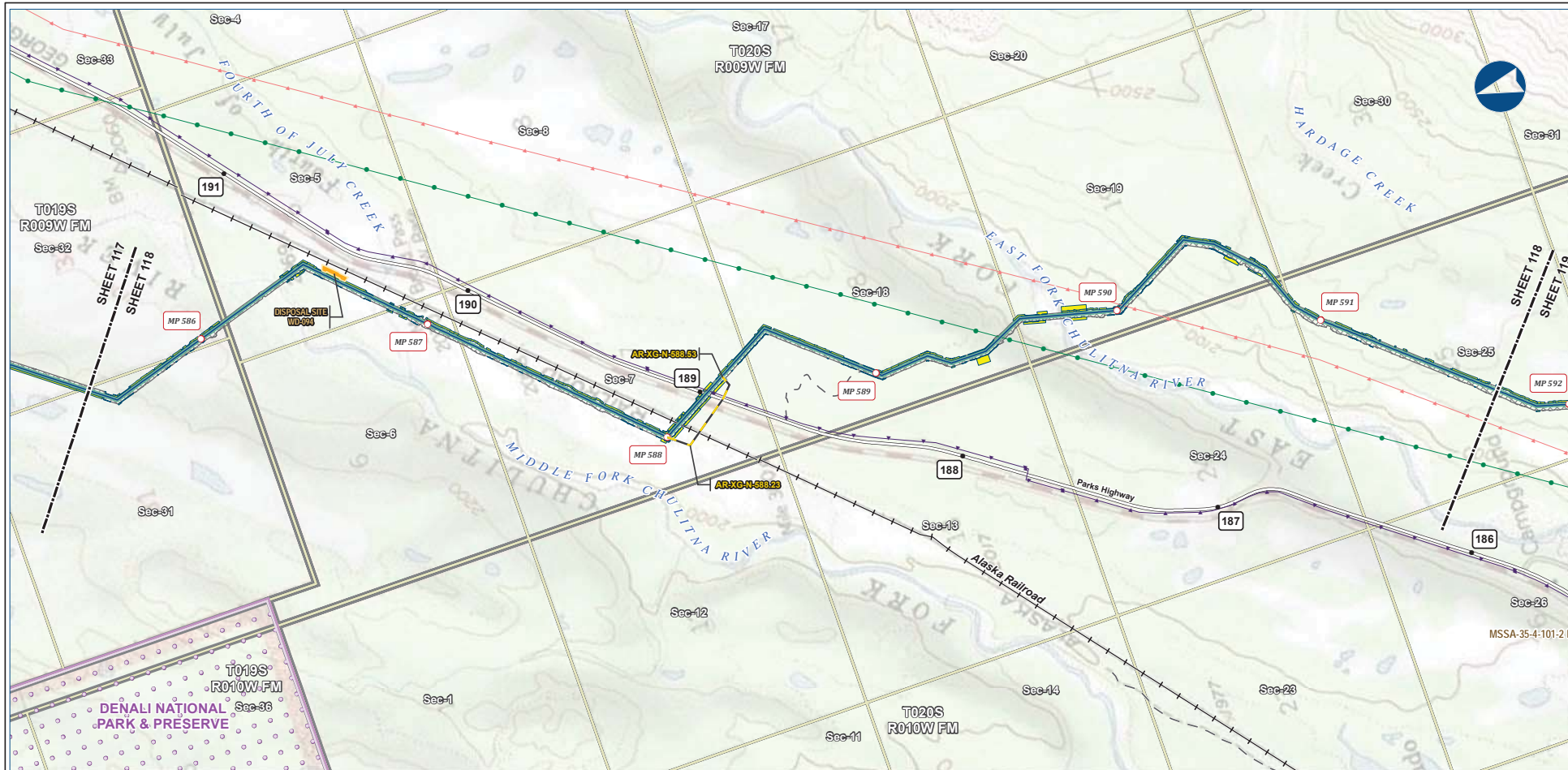

B-125

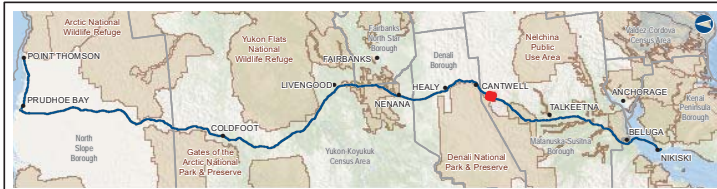

Alaska LNG Project

Legend	
Mainline Pipeline	Permanent ROW
Access Road - Gravel	Construction ROW
Disposal Site	ATWS
Existing Roads	Railroad
Off Road Trails	Buried Cable
Existing Pipeline	Overhead Powerline
Conservation Lands	Section
Township	

ALASKA LNG PROJECT Preliminary Facility Locations Mainline Rev C2 Route			
BOROUGH:	MATANUSKA-SUSITNA	DRAWN BY:	AGDC
STATE:	ALASKA	CHECKED BY:	
REV. NO.:	REVISION	DATE	
A	ISSUED FOR REVIEW	2017-03-10	
PRELIMINARY			
1:24,000			
DATE:	2017-03-10	PROJECTION:	NAD83 NRSR2007 ALASKAZONE4 FTUS S4392

DISCLAIMER

The information contained herein is for informational or planning purposes only. It does not nor should it be deemed to be an offer, request or proposals for rights or occupation of any kind. The Alaska LNG Project Participants and their respective officers, employees and agents, make no warranty, implied or otherwise, nor accept any liability, as to the accuracy or completeness of the information contained in these documents, drawings or electronic files. Do not remove or delete this note from document, drawing or electronic file.

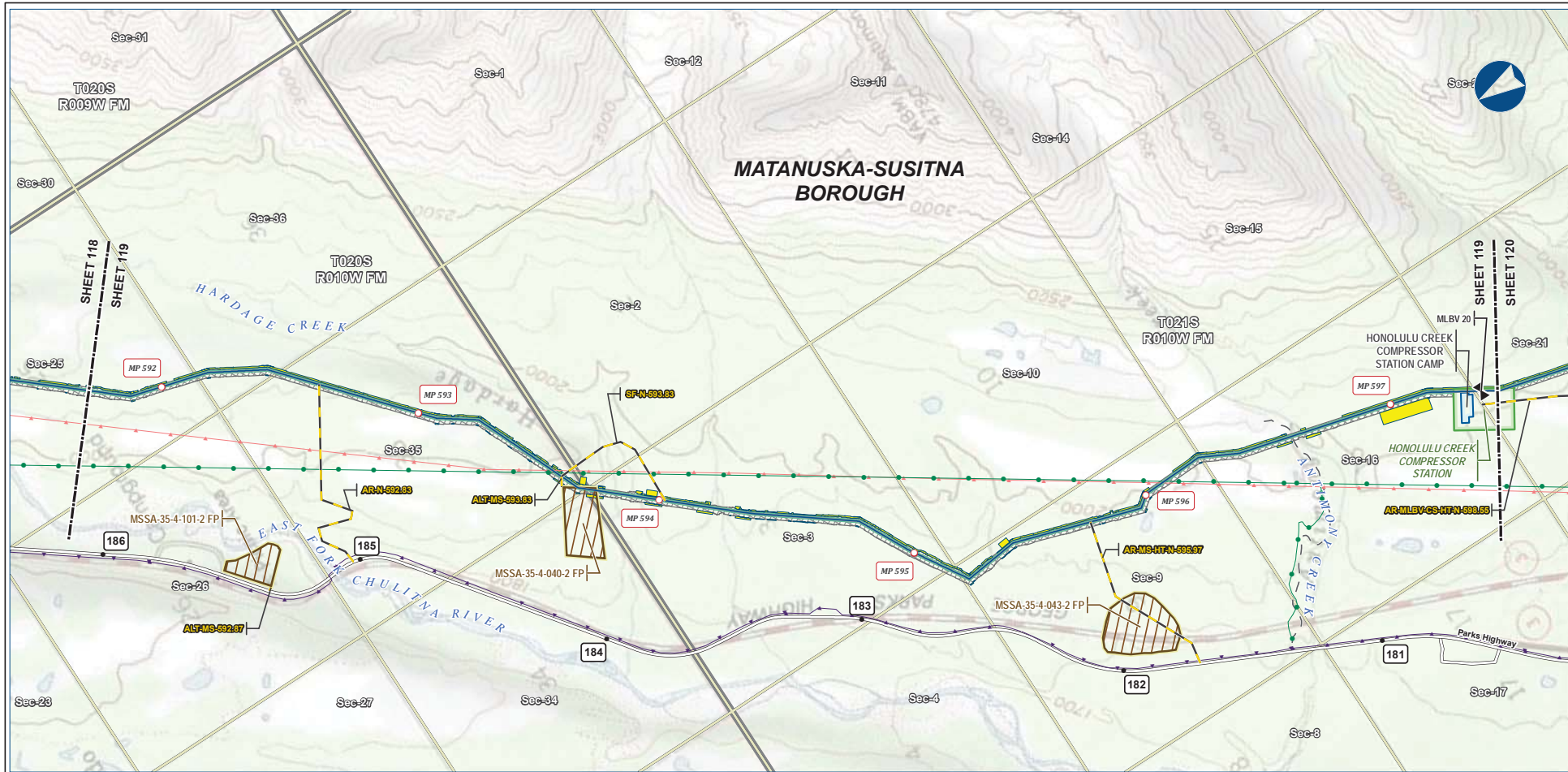

B-126

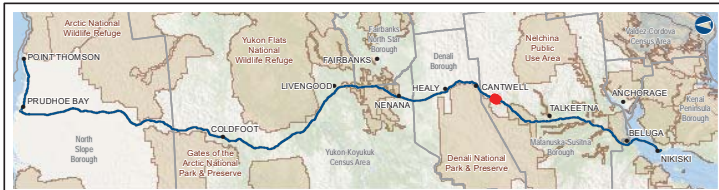

Legend		EXISTING FEATURES	
	Mainline Pipeline		Existing Roads
	Construction ROW		Off Road Trails
	Access Road - Gravel		Buried Cable
	Mainline Blockvalve		Overhead Powerline
	Permanent ROW		Section
	ATWS		Township
	Compressor Station		
	Camp		
	Material Site Study Area (MSSA)		

ALASKA LNG PROJECT			
Preliminary Facility Locations			
Mainline Rev C2 Route			
BOROUGH:	MATANUSKA-SUSITNA	DRAWN BY:	AGDC
STATE:	ALASKA	CHECKED BY:	
REV. NO.:	REVISION	DATE	
A	ISSUED FOR REVIEW	2017-03-10	
PRELIMINARY			
1:24,000			
0 1/4 1/2 3/4 1 Mile			
DATE:	2017-03-10	PROJECTION:	NAD83 NRS2007 ALASKAZONE4 FTUS 54392

DISCLAIMER

The information contained herein is for informational or planning purposes only. It does not nor should it be deemed to be an offer, request or proposals for rights or occupation of any kind. The Alaska LNG Project Participants and their respective officers, employees and agents, make no warranty, implied or otherwise, nor accept any liability, as to the accuracy or completeness of the information contained in these documents, drawings or electronic files. Do not remove or delete this note from document, drawing or electronic file.

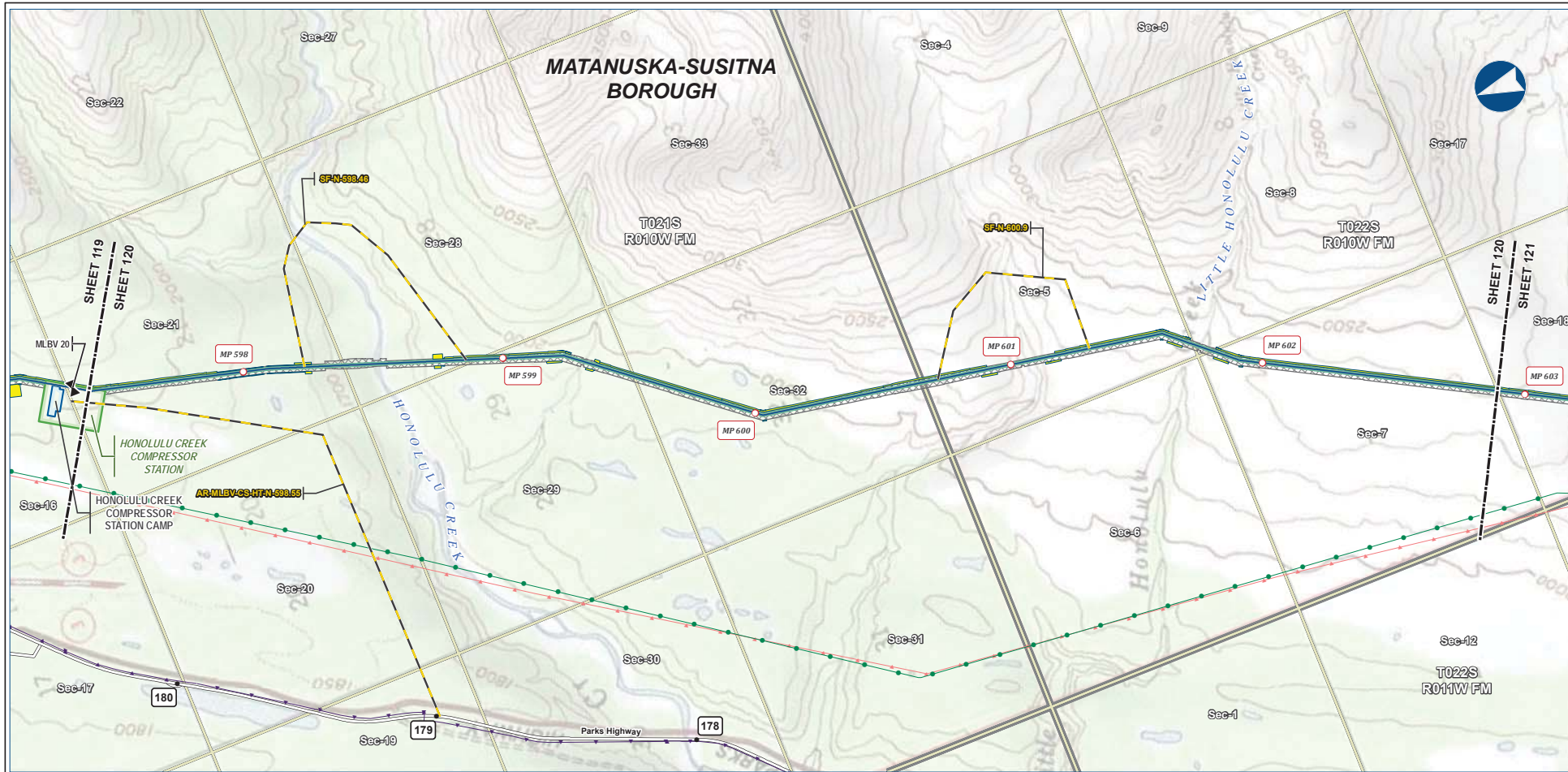

B-127

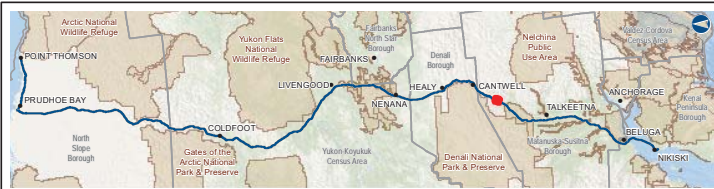

Legend		EXISTING FEATURES	
Pipeline	Permanent ROW	Existing Roads	Existing Pipeline
Mainline Pipeline	Construction ROW	Buried Cable	Overhead Powerline
Access Road - Gravel	ATWS	Section	Township
Mainline Blockvalve	Compressor Station		
	Camp		

ALASKA LNG PROJECT Preliminary Facility Locations Mainline Rev C2 Route			
BOROUGH:	MATANUSKA-SUSITNA	DRAWN BY:	AGDC
STATE:	ALASKA	CHECKED BY:	
REV. NO.:	REVISION	DATE	
A	ISSUED FOR REVIEW	2017-03-10	
PRELIMINARY			
1:24,000			
DATE:	2017-03-10	PROJECTION:	NAD83 NSRS2007 ALASKAZONE4 FTUS 54392

DISCLAIMER
The information contained herein is for informational or planning purposes only. It does not nor should it be deemed to be an offer, request or proposals for rights or occupation of any kind. The Alaska LNG Project Participants and their respective officers, employees and agents, make no warranty, implied or otherwise, nor accept any liability, as to the accuracy or completeness of the information contained in these documents, drawings or electronic files. Do not remove or delete this note from document, drawing or electronic file.

PRELIMINARY FACILITY LOCATIONS - MAINLINE REV C2 ROUTE

ALASKA LNG

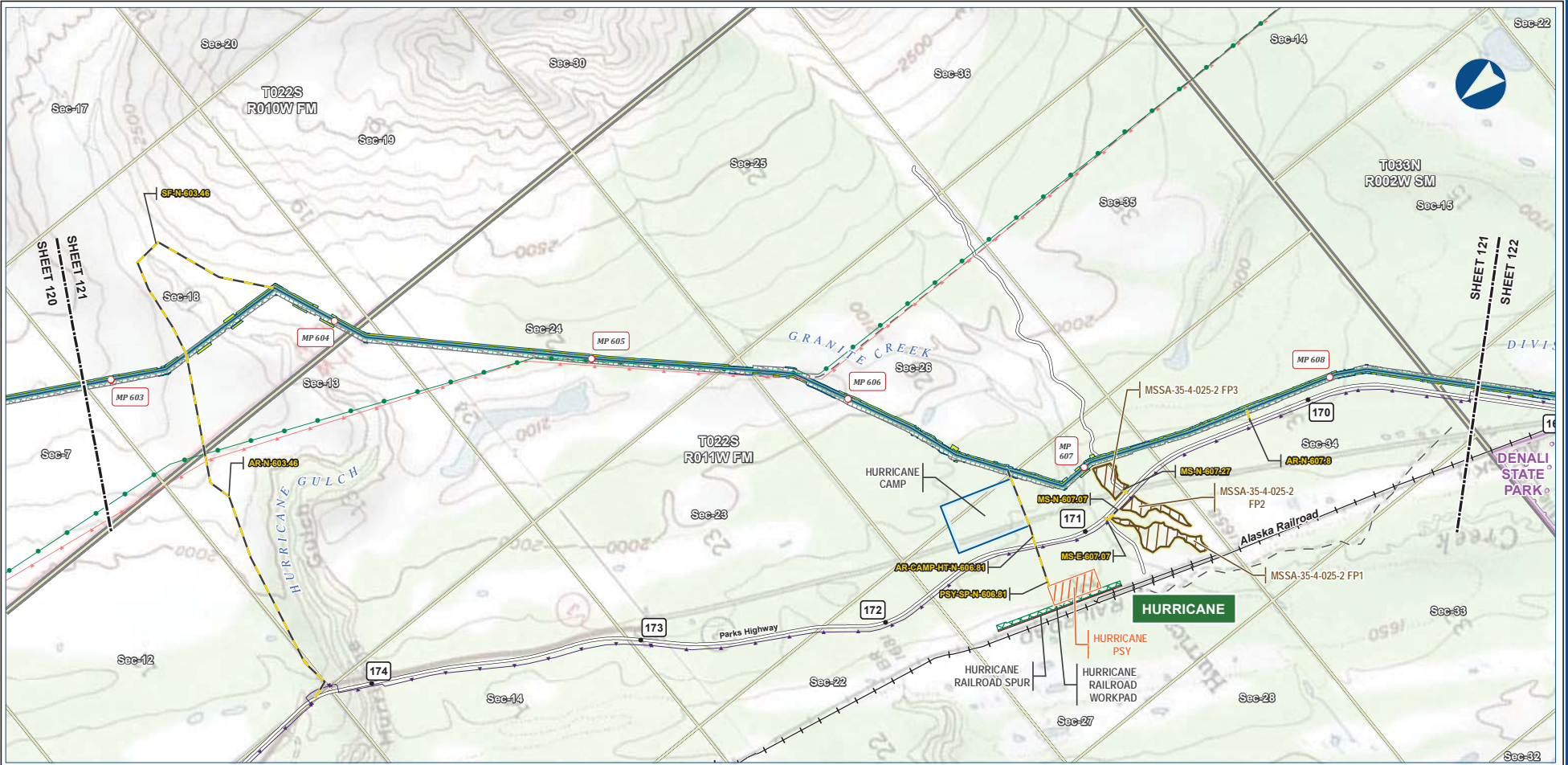

B-128



Legend		EXISTING FEATURES	
	Mainline Pipeline		Existing Roads
	Construction ROW		Railroad
	Access Road - Gravel		Off Road Trails
	Permanent ROW		Existing Pipeline
	Off ROW Camp		Buried Cable
	Pipe Storage Yard (PSY)		Overhead Powerline
	Railroad Workpad		Conservation Lands
	Railroad Spur		Alaska DOT Place Names
	Material Site Study Area (MSSA)		Section
			Township

ALASKA LNG PROJECT Preliminary Facility Locations Mainline Rev C2 Route			
BOROUGH:	MATANUSKA-SUSITNA	DRAWN BY:	AGDC
STATE:	ALASKA	CHECKED BY:	
REV. NO.:	REVISION	DATE	
A	ISSUED FOR REVIEW	2017-03-10	
PRELIMINARY			
1:24,000			
DATE:	2017-03-10	PROJECTION:	NAD83 NRS2007 ALASKAZONE4 FTUS 54392

DISCLAIMER

The information contained herein is for informational or planning purposes only. It does not nor should it be deemed to be an offer, request or proposal for rights or occupation of any kind. The Alaska LNG Project Participants and their respective officers, employees and agents, make no warranty, implied or otherwise, nor accept any liability, as to the accuracy or completeness of the information contained in these documents, drawings or electronic files. Do not remove or delete this note from document, drawing or electronic file.

Alaska LNG Project

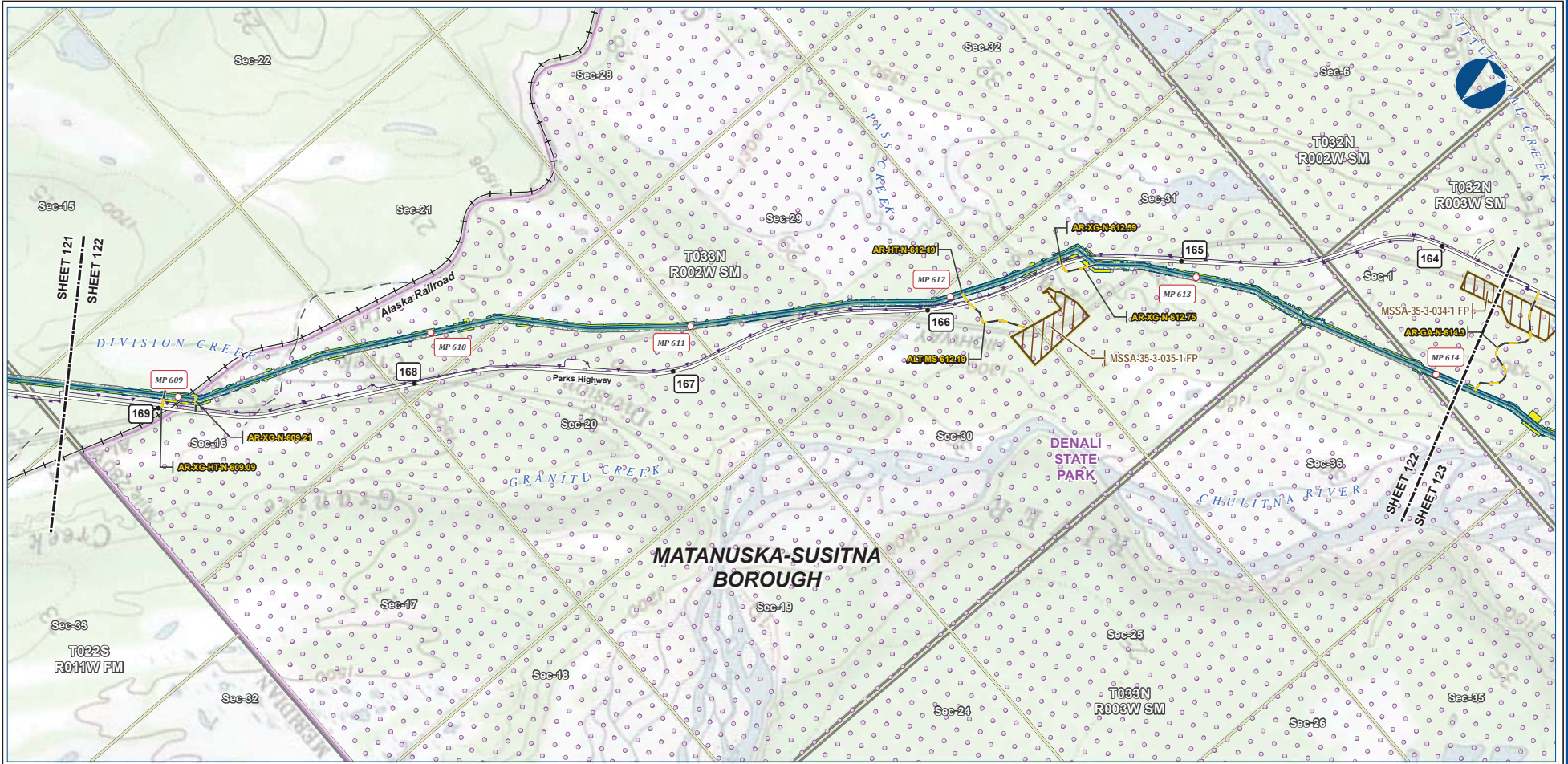

B-129

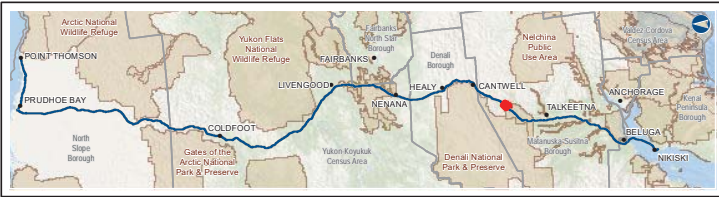

Legend		EXISTING FEATURES	
Pipeline	Permanent ROW	Existing Roads	Railroad
Access Road - Gravel	Construction ROW	Off Road Trails	Buried Cable
	ATWS	Conservation Lands	Section
	Material Site Study Area (MSSA)	Township	

ALASKA LNG PROJECT Preliminary Facility Locations Mainline Rev C2 Route			
BOROUGH:	MATANUSKA-SUSITNA	DRAWN BY:	AGDC
STATE:	ALASKA	CHECKED BY:	
REV. NO.	REVISION	DATE	
A	ISSUED FOR REVIEW	2017-03-10	
PRELIMINARY			
1:24,000			
DATE:	2017-03-10	PROJECTION:	NAD83 NRSR2007 ALASKAZONE4 FTUS S4392

DISCLAIMER

The information contained herein is for informational or planning purposes only. It does not nor should it be deemed to be an offer, request or proposals for rights or occupation of any kind. The Alaska LNG Project Participants and their respective officers, employees and agents, make no warranty, implied or otherwise, nor accept any liability, as to the accuracy or completeness of the information contained in these documents, drawings or electronic files. Do not remove or delete this note from document, drawing or electronic file.

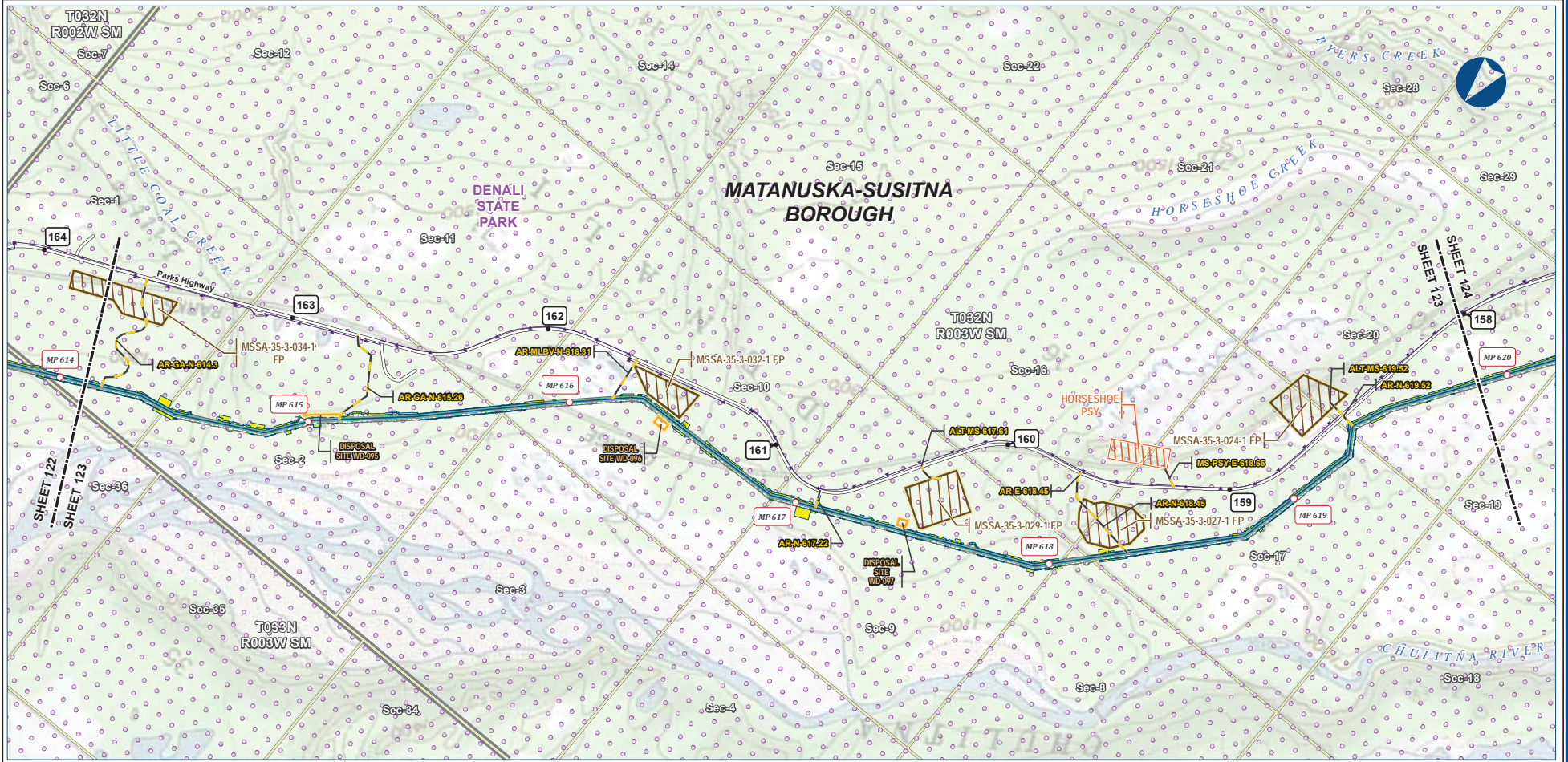

B-130

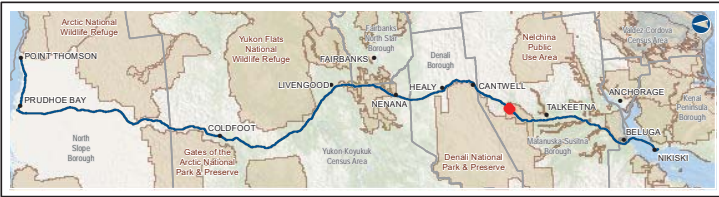

Legend		EXISTING FEATURES	
	Mainline Pipeline		Existing Roads
	Construction ROW		Buried Cable
	Access Road - Gravel		Conservation Lands
	ATWS		Section
	Pipe Storage Yard (PSY)		Township
	Disposal Site		
	Material Site Study Area (MSSA)		

ALASKA LNG PROJECT			
Preliminary Facility Locations			
Mainline Rev C2 Route			
BOROUGH:	MATANUSKA-SUSITNA	DRAWN BY:	AGDC
STATE:	ALASKA	CHECKED BY:	
REV. NO.:	REVISION	DATE	
A	ISSUED FOR REVIEW	2017-03-10	
PRELIMINARY			
1:24,000			
DATE:	2017-03-10	PROJECTION:	NAD83 NSRS2007 ALASKAZONE4 FTUS 54392

DISCLAIMER

The information contained herein is for informational or planning purposes only. It does not nor should it be deemed to be an offer, request or proposals for rights or occupation of any kind. The Alaska LNG Project Participants and their respective officers, employees and agents, make no warranty, implied or otherwise, nor accept any liability, as to the accuracy or completeness of the information contained in these documents, drawings or electronic files. Do not remove or delete this note from document, drawing or electronic file.

PRELIMINARY FACILITY LOCATIONS - MAINLINE REV C2 ROUTE

ALASKA LNG

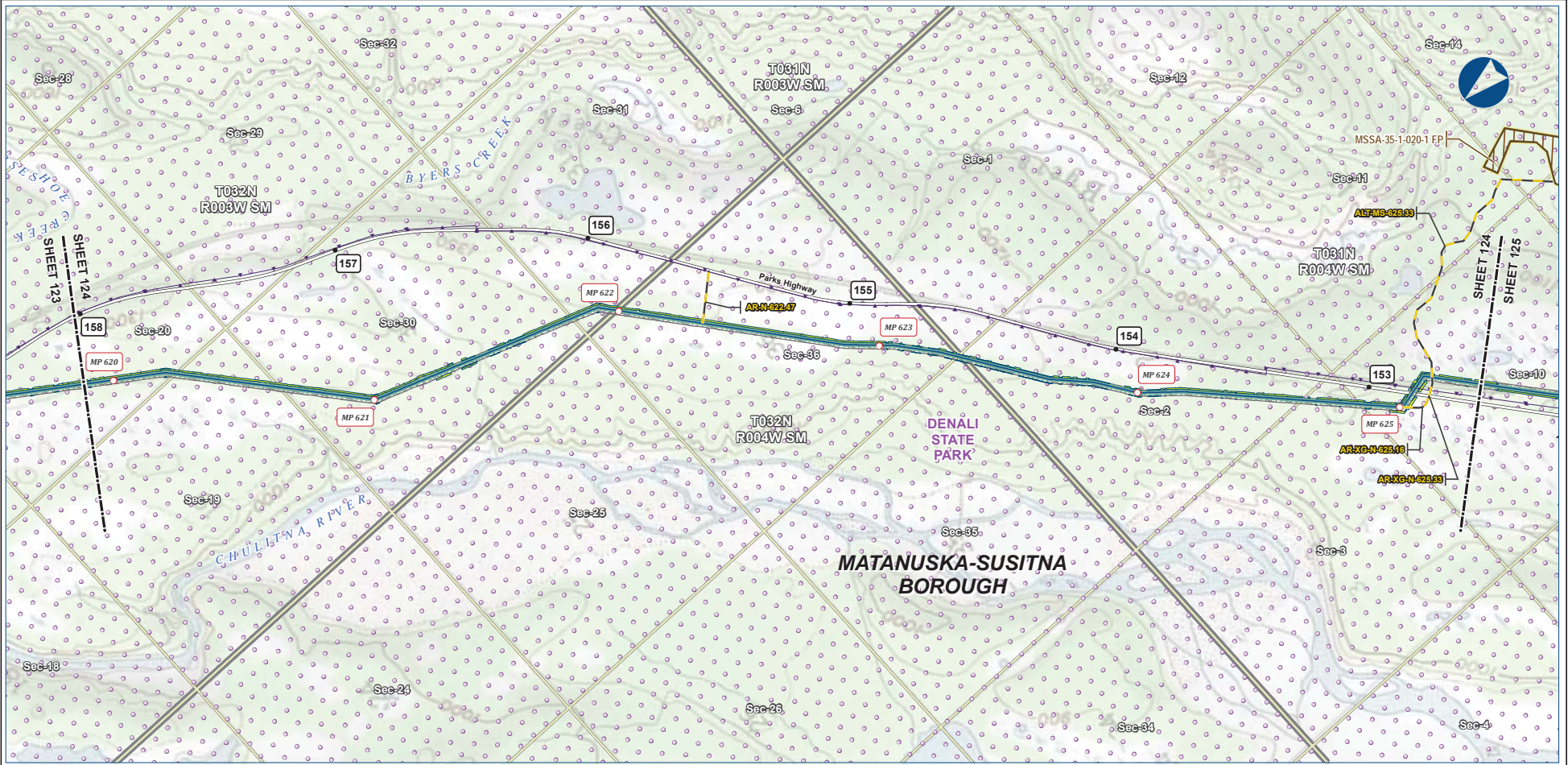

B-131

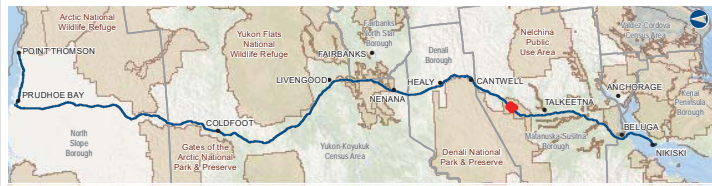

Legend

PIPELINE	Permanent ROW	Existing Roads
Mainline Pipeline	Construction ROW	Buried Cable
Access Road - Gravel	ATWS	Conservation Lands
	Material Site Study Area (MSSA)	Section
		Township

ALASKA LNG PROJECT
Preliminary Facility Locations
Mainline Rev C2 Route

BOROUGH:	MATANUSKA-SUSITNA	DRAWN BY:	AGDC
STATE:	ALASKA	CHECKED BY:	
REV. NO.:	REVISION	DATE	
A	ISSUED FOR REVIEW	2017-03-10	
PRELIMINARY			
1:24,000			
0 1/4 1/2 3/4 1 MILE			
DATE:	2017-03-10	PROJECTION:	NAD83 NRSR2007 ALASKAZONE4 FTUS 54392

DISCLAIMER

The information contained herein is for informational or planning purposes only. It does not nor should it be deemed to be an offer, request or proposals for rights or occupation of any kind. The Alaska LNG Project Participants and their respective officers, employees and agents, make no warranty, implied or otherwise, nor accept any liability, as to the accuracy or completeness of the information contained in these documents, drawings or electronic files. Do not remove or delete this note from document, drawing or electronic file.

Alaska LNG Project

PRELIMINARY FACILITY LOCATIONS - MAINLINE REV C2 ROUTE

ALASKA LNG

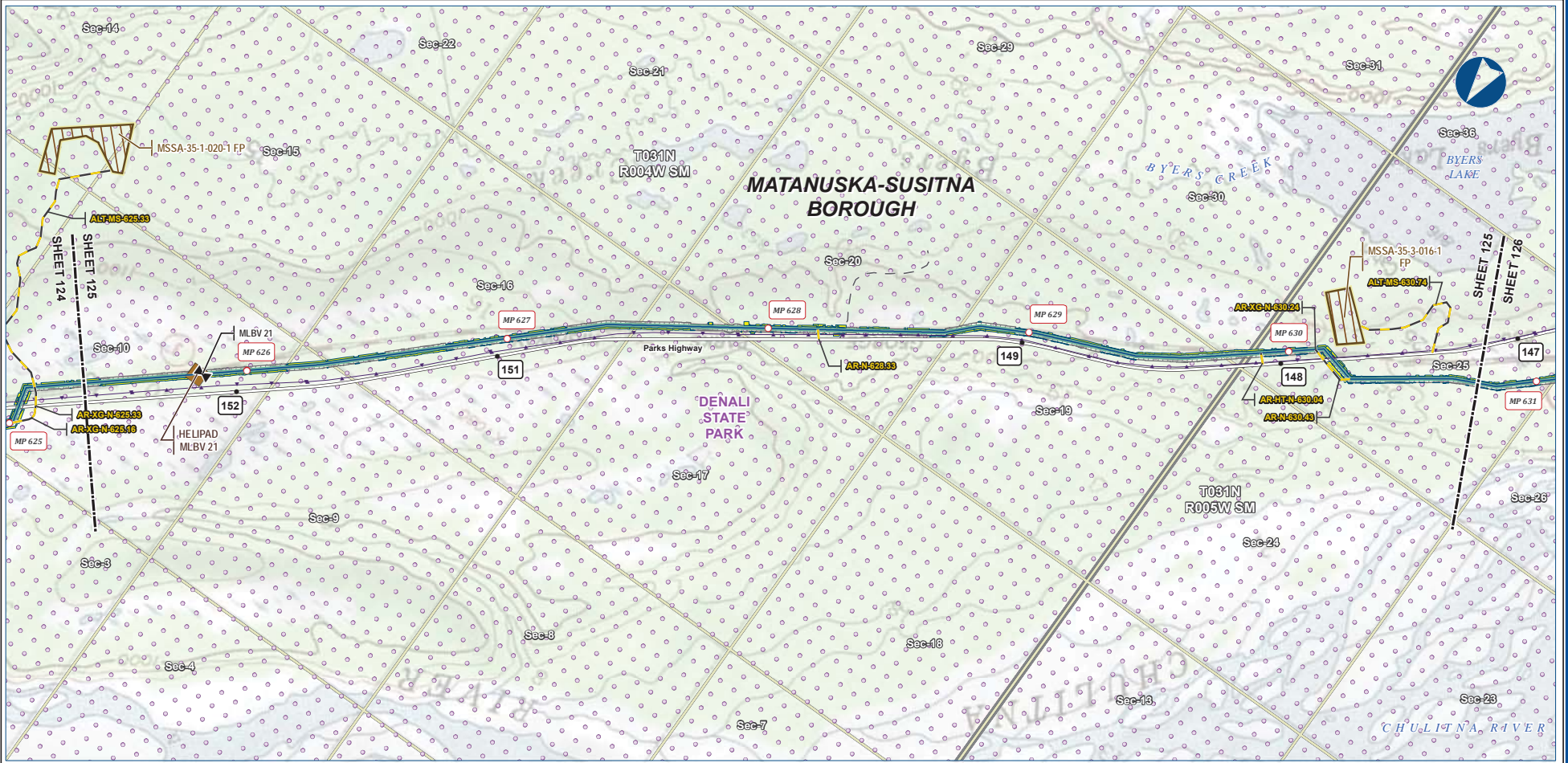

B-132

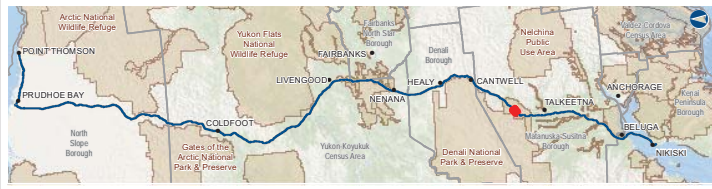

Legend		EXISTING FEATURES	
Mainline Pipeline	Permanent ROW	Existing Roads	Off Road Trails
Access Road - Gravel	Construction ROW	Buried Cable	Conservation Lands
Mainline Blockvalve	ATWS	Material Site Study Area (MSSA)	Section
Helipad			Township

ALASKA LNG PROJECT Preliminary Facility Locations Mainline Rev C2 Route			
BOROUGH:	MATANUSKA-SUSITNA	DRAWN BY:	AGDC
STATE:	ALASKA	CHECKED BY:	
REV. NO.:	REVISION	DATE	
A	ISSUED FOR REVIEW	2017-03-10	
PRELIMINARY			
1:24,000			
DATE:	2017-03-10	PROJECTION:	NAD83 NRSR2007 ALASKAZONE4 FTUS S4392

DISCLAIMER

The information contained herein is for informational or planning purposes only. It does not nor should it be deemed to be an offer, request or proposals for rights or occupation of any kind. The Alaska LNG Project Participants and their respective officers, employees and agents, make no warranty, implied or otherwise, nor accept any liability, as to the accuracy or completeness of the information contained in these documents, drawings or electronic files. Do not remove or delete this note from document, drawing or electronic file.

Alaska LNG Project

PRELIMINARY FACILITY LOCATIONS - MAINLINE REV C2 ROUTE

ALASKA LNG

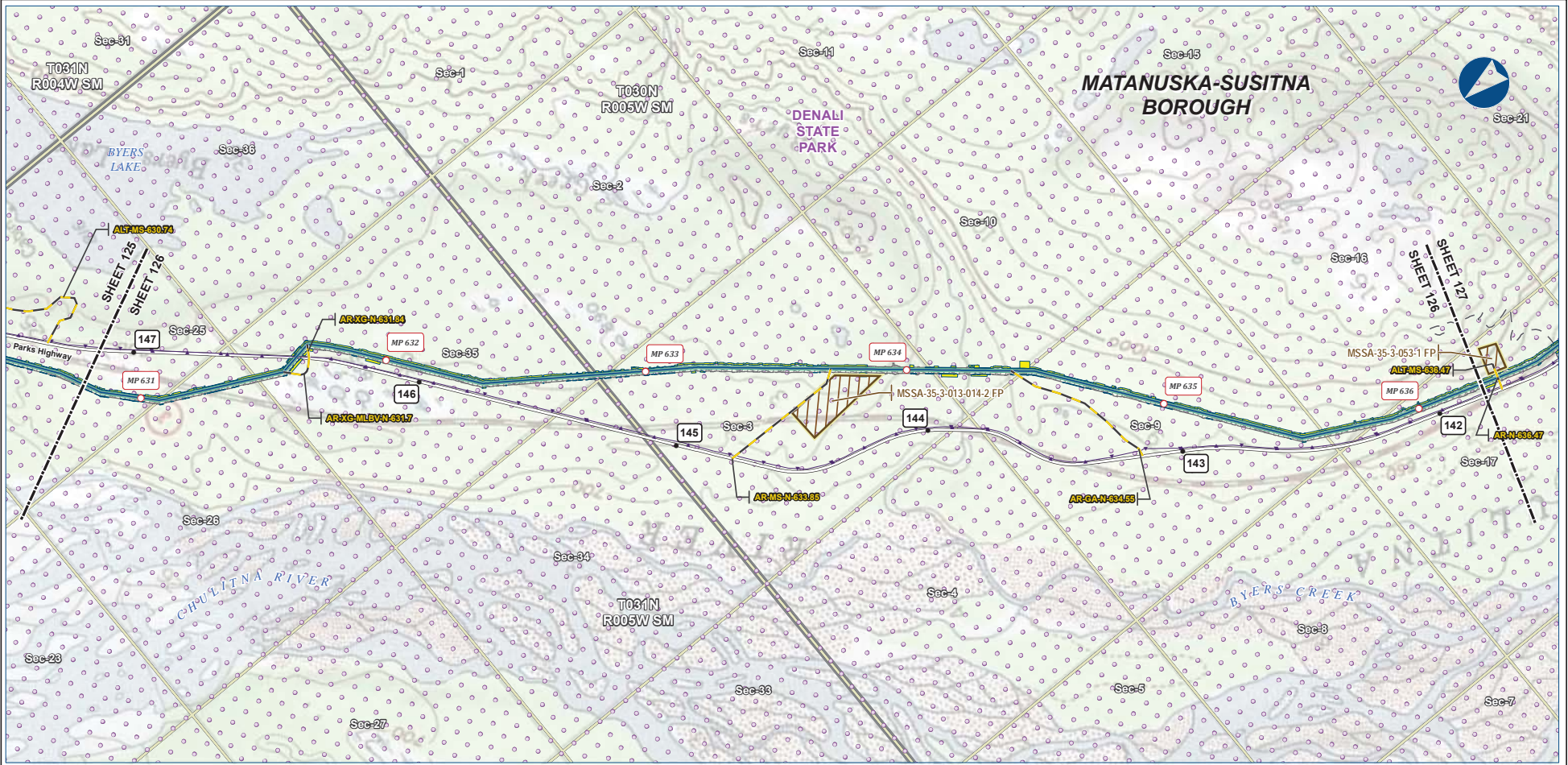

B-133



Legend		EXISTING FEATURES	
	Mainline Pipeline		Existing Roads
	Construction ROW		Off Road Trails
	Access Road - Gravel		Buried Cable
	Permanent ROW		Conservation Lands
	ATWS		Section
	Material Site Study Area (MSSA)		Township

ALASKA LNG PROJECT			
Preliminary Facility Locations			
Mainline Rev C2 Route			
BOROUGH:	MATANUSKA-SUSITNA	DRAWN BY:	AGDC
STATE:	ALASKA	CHECKED BY:	
REV. NO.:	REVISION	DATE	
A	ISSUED FOR REVIEW	2017-03-10	
PRELIMINARY			
1:24,000			
DATE:	2017-03-10	PROJECTION:	NAD83 NRSR2007 ALASKAZONE4 FTUS S4392

DISCLAIMER

The information contained herein is for informational or planning purposes only. It does not nor should it be deemed to be an offer, request or proposals for rights or occupation of any kind. The Alaska LNG Project Participants and their respective officers, employees and agents, make no warranty, implied or otherwise, nor accept any liability, as to the accuracy or completeness of the information contained in these documents, drawings or electronic files. Do not remove or delete this note from document, drawing or electronic file.

Alaska LNG Project

PRELIMINARY FACILITY LOCATIONS - MAINLINE REV C2 ROUTE

ALASKA LNG

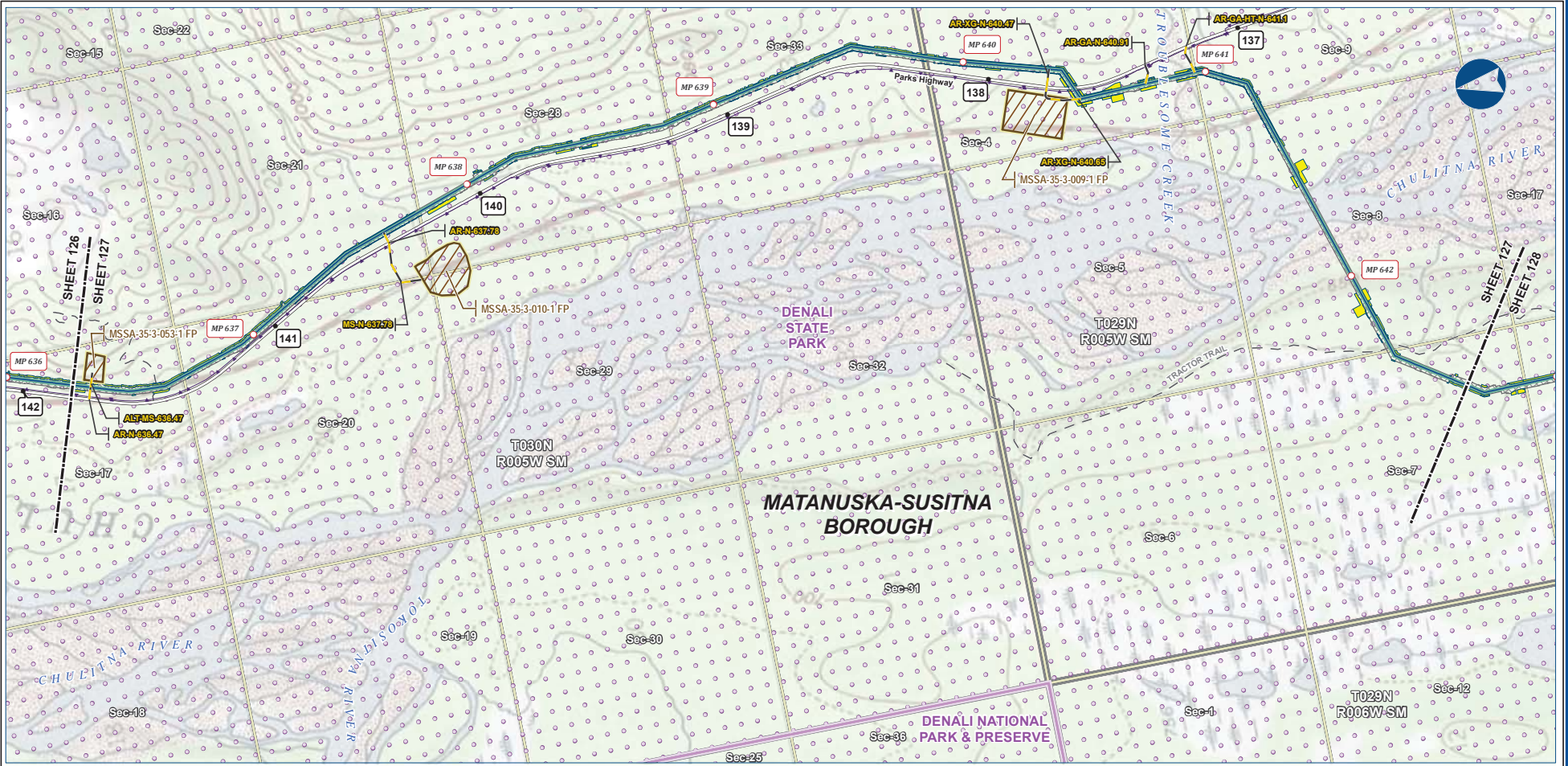

B-134



Legend

Mainline Pipeline	Permanent ROW	Existing Roads
Access Road - Gravel	Construction ROW	Off Road Trails
	ATWS	Buried Cable
	Material Site Study Area (MSSA)	Conservation Lands
		Section
		Township

ALASKA LNG PROJECT
Preliminary Facility Locations
Mainline Rev C2 Route

BOROUGH:	MATANUSKA-SUSITNA	DRAWN BY:	AGDC
STATE:	ALASKA	CHECKED BY:	
REV. NO.:	A	REVISION	ISSUED FOR REVIEW
		DATE	2017-03-10
PRELIMINARY			
1:24,000			
DATE:	2017-03-10	PROJECTION:	NAD83 NSRS2007 ALASKAZONE4 FTUS 54392

DISCLAIMER

The information contained herein is for informational or planning purposes only. It does not nor should it be deemed to be an offer, request or proposals for rights or occupation of any kind. The Alaska LNG Project Participants and their respective officers, employees and agents, make no warranty, implied or otherwise, nor accept any liability, as to the accuracy or completeness of the information contained in these documents, drawings or electronic files. Do not remove or delete this note from document, drawing or electronic file.

Alaska LNG Project

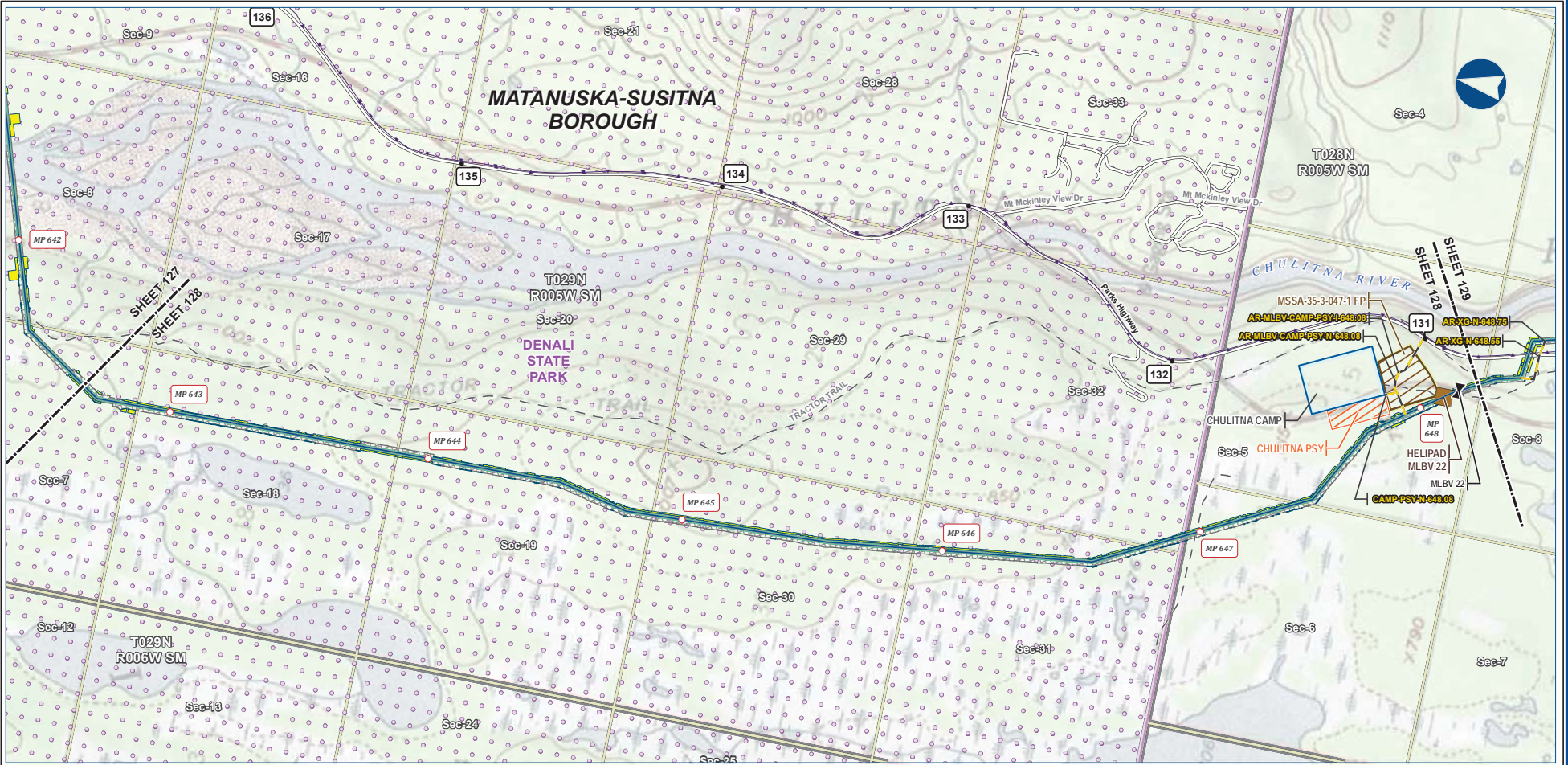

B-135



Legend

PIPELINE	Permanent ROW	EXISTING FEATURES
Mainline Pipeline	Construction ROW	Existing Roads
Access Road - Gravel	ATWS	Off Road Trails
Mainline Blockvalve	Off ROW Camp	Buried Cable
Helipad	Pipe Storage Yard (PSY)	Conservation Lands
	Material Site Study Area (MSSA)	Section
		Township

ALASKA LNG PROJECT
Preliminary Facility Locations
Mainline Rev C2 Route

BOROUGH:	MATANUSKA-SUSITNA	DRAWN BY:	AGDC
STATE:	ALASKA	CHECKED BY:	
REV. NO.:	REVISION	DATE	
A	ISSUED FOR REVIEW	2017-03-10	
PRELIMINARY			
1:24,000			
DATE:	2017-03-10	PROJECTION:	NAD83 NRSR2007 ALASKAZONE4 FTUS 54392

DISCLAIMER

The information contained herein is for informational or planning purposes only. It does not nor should it be deemed to be an offer, request or proposals for rights or occupation of any kind. The Alaska LNG Project Participants and their respective officers, employees and agents, make no warranty, implied or otherwise, nor accept any liability, as to the accuracy or completeness of the information contained in these documents, drawings or electronic files. Do not remove or delete this note from document, drawing or electronic file.

Mainline Facilities
(cont'd in appendix B volume 4)